

4 3 2 1 936140

D C B A

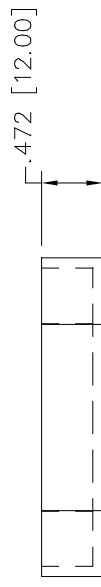
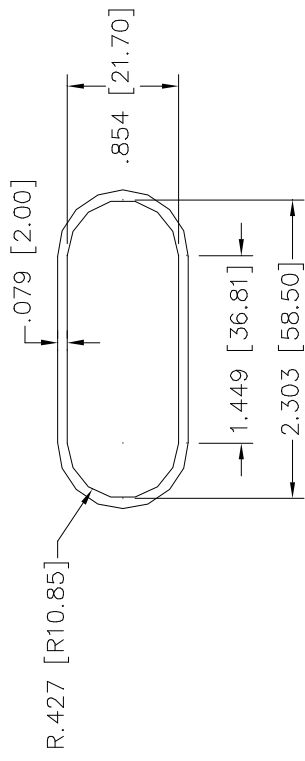
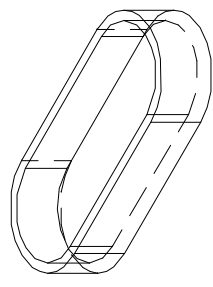

NOTES:

1. BREAK ALL SHARP EDGES.
2. MATERIAL: PVC
3. COLOR: BLACK

UNLESS OTHERWISE SPECIFIED:		INSPIRED ENERGY®		3rd ANGLE PROJ. CHECK		BILL OF MAT'L. NEXT ASSEMBLY	
1. ALL MACHINED SURFACES TO BE 63 MICROINCHES OR SMOOTHER.		SOLUTIONS FOR PORTABLE POWER		DRAWN M. ORLER		DUST CAP, 2040 SERIES	
2. ALL DIMENSIONS ARE IN INCHES.		NEWBERRY, FLORIDA		DATE 2/5/07		SCALE 1:1 SHEET 1 OF 1	
TOLERANCES:		ANGLE ±1/4°		APPROVE		ENGINEERING NO. 936140	
.XX ±.02	FRACTIONS ± 1/64			DATE ISSUED		DWG. REV. B1	
.XXX ±.005	ANGLE ±1/4°			MACHINE NAME:		SIZE	
.XXXX ±.0005				These documents, submitted by Inspired Energy Inc., contain information of a proprietary nature and shall not be copied or duplicated in whole or in part or used in whole or in part for any purpose other than that which is necessary for the preparation of bids or fabrication.		1	
REVISONS		4		2		3	

10/10/2002